

REVISIONS			
REV	DESCRIPTION	DATE	APPROVED
A	INITIAL RELEASE ECO 7249	1/11/16	J KORDIK

GEAR HEAD LENGTH	
PART NUMBER	'L'
23PN-1STAGE	3.06
23PN-2STAGE	3.97

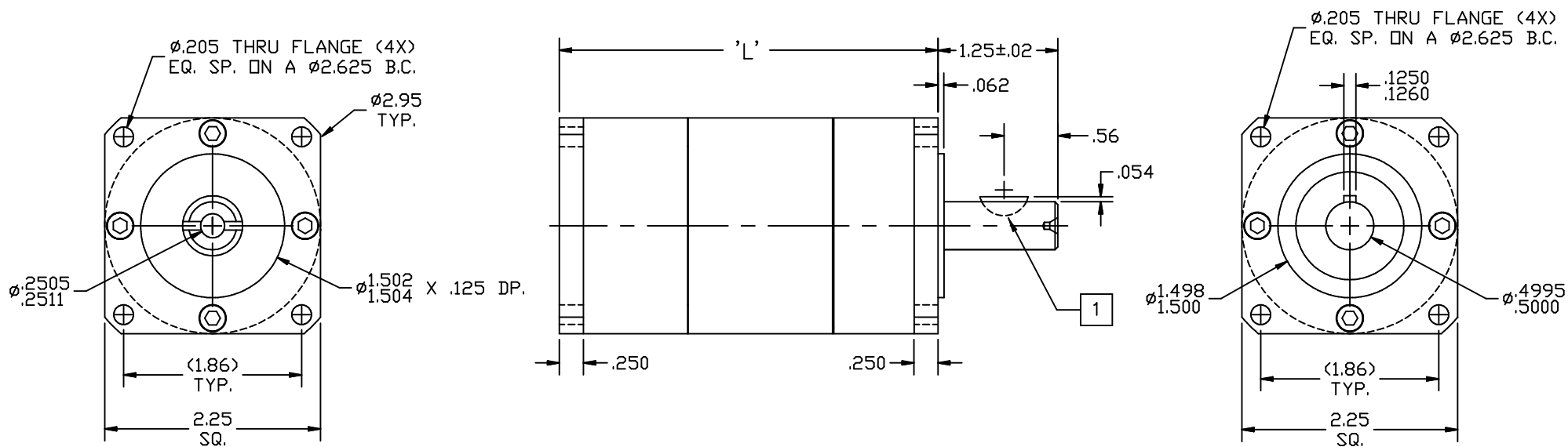

NOTES: UNLESS OTHERWISE SPECIFIED

- 1 #404 WOODRUFF KEY.
2. FOR TECHNICAL DETAILS, CONTACT APPLIED MOTION PRODUCTS.
3. SOME GEAR HEADS REQUIRE A CUSTOM ADAPTER, CHECK WHEN ORDERING.

GEAR RATIOS OFFERED		
GEAR HEAD:	RATIO:	DASH NO.
23PN-1STAGE	5.5:1	-0055
	10:1	-010
23PN-2STAGE	28:1	-028
	70:1	-070
	100:1	-100

TOLERANCES		THIRD ANGLE PROJECTION	
DECIMALS: INCH (MM) X.XXX = ±.005 (0.013) X.XX = ±.01 (0.25) X.X = ±0.1 (2.5)			
ANGLES: MACH. = ±5° CHAM. = ±5°		APPROVALS DRAWN R JONEZ CHECKED	DATE 11/3/15
COMPUTER DATA BASE DRAWING		APPROVED	SCALE: FULL



**OUTLINE, GEAR HEAD,  
PN23, SINGLE AND DOUBLE STAGE**

B DWG NO. 23PN-XXX REV A

SHEET 1 OF 1