

REVISIONS			
REV	DESCRIPTION	DATE	APPROVED
A	INITIAL RELEASE ECO 8140	1/29/19	M.Maroney

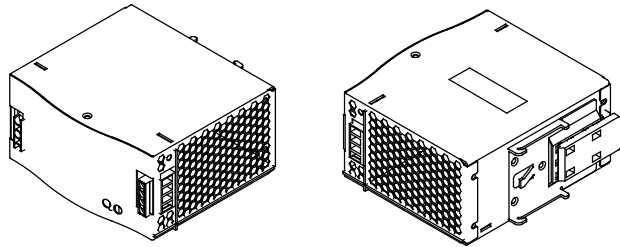

— LABEL — LOGO, 1000-379, 48V, 240W, DIN RAIL MOUNT.

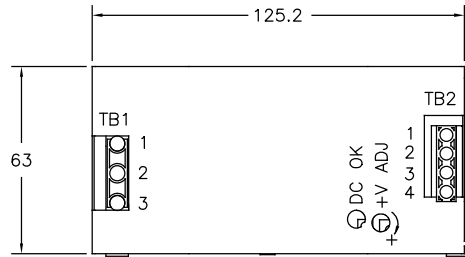
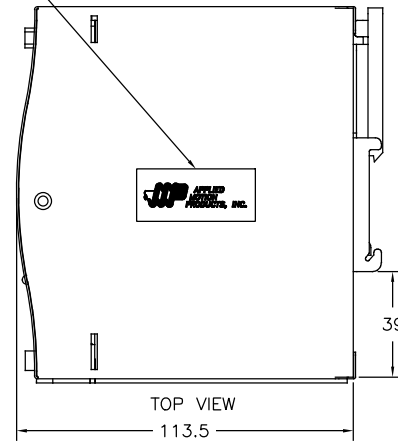

FRONT VIEW

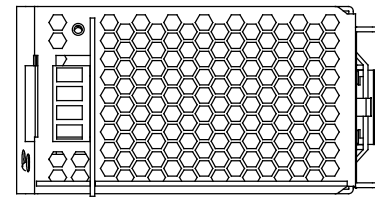

SIDE VIEW

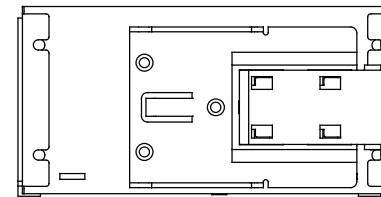

REAR VIEW

TB1 CONNECTIONS	
PIN #	SIGNAL
PIN 1	FRAME GROUND
PIN 2	AC/N OR DC-
PIN 3	AC/L OR DC+

TB2 CONNECTIONS	
PIN #	SIGNAL
PIN 1	DC OUTPUT -V
PIN 2	DC OUTPUT -V
PIN 3	DC OUTPUT +V
PIN 4	DC OUTPUT +V

- NOTES: UNLESS OTHERWISE SPECIFIED
1. THIS ASSEMBLY TO BE MANUFACTURED IN COMPLIANCE WITH THE CURRENT EU RoHS DIRECTIVE.
 2. FITS DIN RAIL TS35/7.5 OR TS35/15.

THIS SHEET DESCRIBES OVERALL SIZE AND MOUNTING.
FOR LATEST SPECIFICATIONS, REFER TO APPLIED MOTION WEBSITE: www.applied-motion.com

THIRD ANGLE PROJECTION

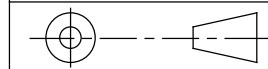

FINISH:

MATERIAL:

TOLERANCES

DECIMALS: MM (INCH)
 X.XXX = ±0.127 (.005)
 X.XX = ±0.25 (.01)
 X.X = ±2.5 (0.1)
 ANGLES:
 MACH. = ±.5°
 CHAM. = ±5°

CONTRACT NO. _

APPROVALS

DATE

DRAWN *R.JONEZ*

1/25/19

CHECKED

APPROVED

APPROVED



APPLIED MOTION PRODUCTS, INC.

POWER SUPPLY, PS240D48
48V, 240W DIN-RAIL MOUNT

D

FSCM NO.

DWG NO.

1000-379

REV

A

SCALE: NONE

SHEET 1 OF 1